



## ACCESSORY SETUP INSTRUCTION

### FRONT BUMPER ASSEMBLY -- PN 9DS#-801400-6000

VALID FOR: MY2020 CFORCE 600 / 625 & CFORCE 600 TOURING / 625 TOURING

**BEFORE YOU BEGIN:** Read and understand the instructions before starting any work. Make sure that all parts are ready and that you have all the tools required for assembly.

**NOTE:** CFMOTO shall not be liable for any damage caused by incorrect assembly. CFMOTO recommends that all original accessories be assembled by an authorized CFMOTO dealer.

Before assembly, park the vehicle on a flat surface, put the transmission gear into Park (P) and turn off the key switch.

**Zhejiang CFMOTO Power Co., Ltd.** All rights reserved. Reproduction of this document, even in part, as well as copying of all kinds, is permitted only with the express written permission of the copyright owner.

### MEANING OF SYMBOLS

 - Indicates information with more details or tips.

 - Indicates information of warning or danger.

### PARTS LIST: WASHER 6x12x1.6

S/N	PART NAME	PART NUMBER	QTY.	REMARK
1	FRONT BUMPER ASSEMBLY	9DS#-801400-6000	1	
2	FRONT BUMPER	9DS#-801410-6000	1	
3	PLUG 32	9DS#-801400-6000-20	4	
4	SCREW M6x12	9DS#-801200-6000-22	2	
5	WASHER 6x12x1.6	9DS#-801200-6000-21	2	

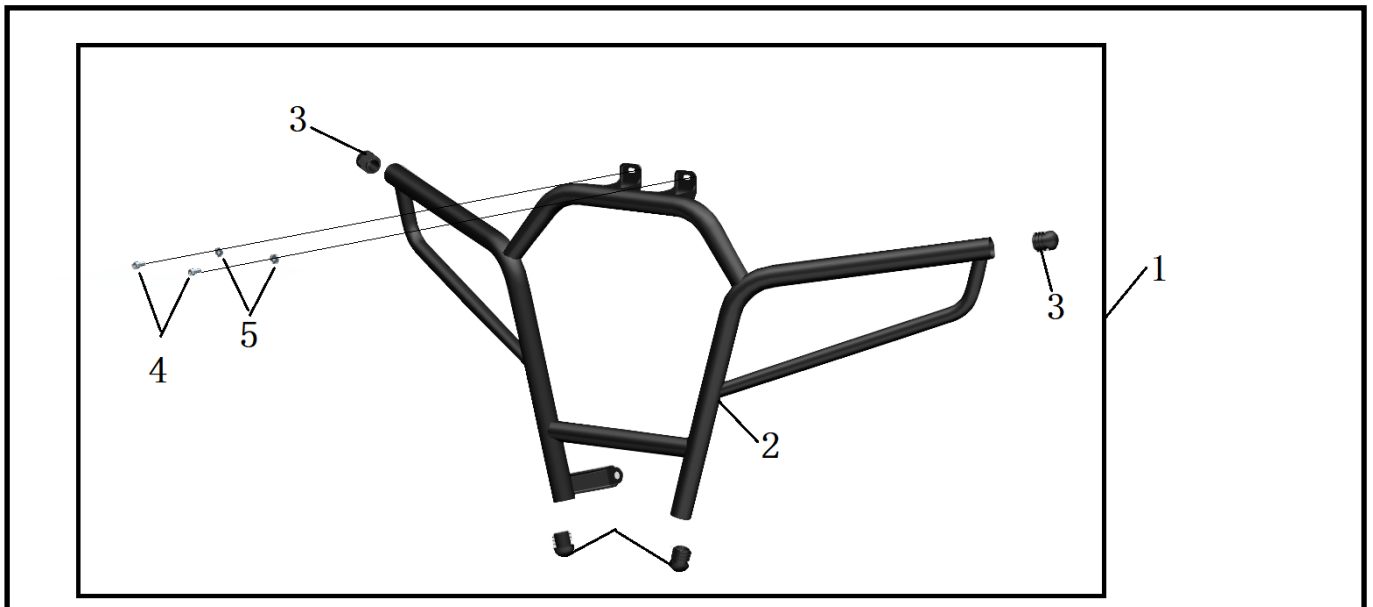

### TOOL LIST:

Item	Description	QTY.	REMARK
1	SOCKET WRENCH	1	Recommended tools
2	SOCKET EXTENSION	1	
3	13mm SOCKET	1	
4	RUBBER HAMMER	1	
5	5mm INNER HEX	1	
6	PROTECTIVE GLOVES	1	

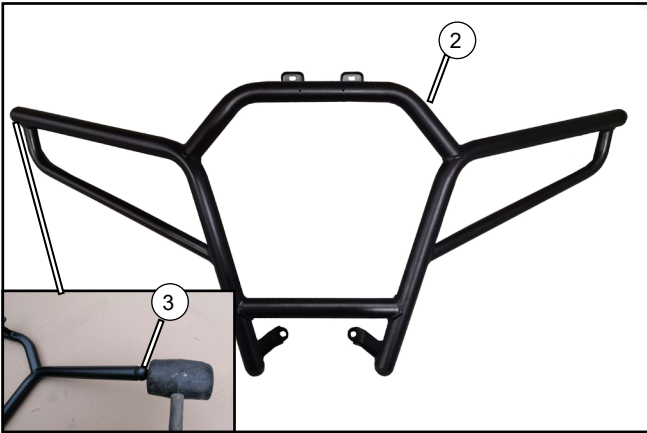

// Use a rubber hammer to install the plugs (3) into the front bumper (2).



// Remove the front middle rack cover (1).



// Turn on the main key switch, then press and hold the winch 'OUT' button to let out the winch rope approximately 30cm.

---

**!** Only power the vehicle, no need to start.

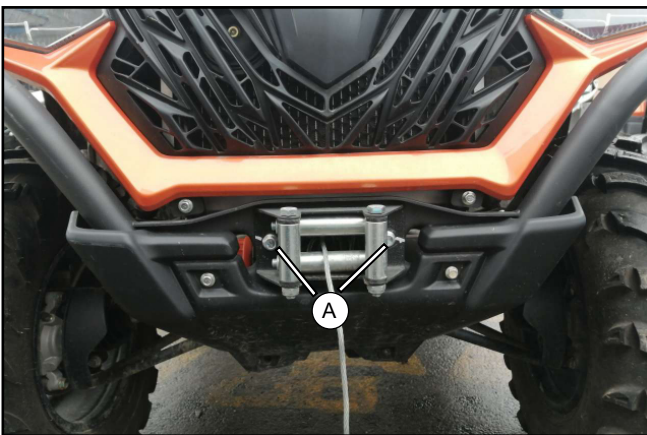

// Remove the winch fairlead bolts (A).

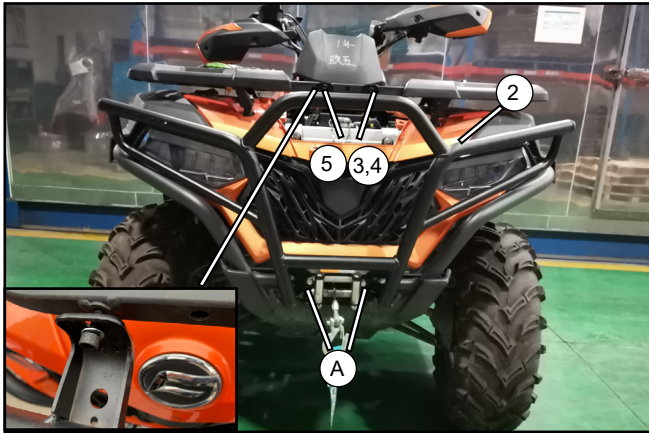

### Install the front bumper assembly:

- // Place washers (5) on hex screws (4). Align the upper bumper mount (2) to the front rack mounting holes, then install the M6x12 bolts (3,4). *Do not fully tighten bolts at this time.*
- // Align the winch fairlead and lower bumper mount to the mounting holes, then install the previously removed M10x25 bolts (A).
- // Tighten all bolts to the specified torque value.
- // Retract the winch rope.

**i** NOTE: Bumper is placed on top of the winch fairlead.

BOLT	M10×25	30004-100025810	70-80N.m
WASHER	6x12x1.6	30300-060172	/
SCREW	M6x12	30102-060012870	8-10N.m