

ACCESSORY SETUP INSTRUCTION

UPPER SOFT DOOR ASSY. -- PN 5BWV-807000-5000

VALID FOR: MY2022 and Newer ZFORCE Trail 800 (G2 only)

BEFORE YOU BEGIN: Read and understand the instructions before starting any work. Make sure that all parts are ready and that you have all the tools required for assembly.

NOTE: CFMOTO shall not be liable for any damage caused by incorrect assembly. CFMOTO recommends that all original accessories be assembled by an authorized CFMOTO dealer.

Before assembly, park the vehicle on a flat surface, put the transmission gear into Park (P) and turn off the key switch.

Zhejiang CFMOTO Power Co., Ltd. All rights reserved. Reproduction of this document, even in part, as well as copying of all kinds, is permitted only with the express written permission of the copyright owner.

MEANING OF SYMBOLS



- Indicates information with more details or tips.



- Indicates information of warning or danger.

PARTS LIST:

ITEM	PART NAME	PART NUMBER	QTY.	REMARK
1	UPPER SOFT DOOR ASSY.	5BWV-807000-5000	1	For structure reference only
2	UPPER SOFT DOOR	5BWV-807200-5000	2	
3	BOLT M6×20	30006-060020870	4	
4	BOLT M6×16	5BWV-807100-5000-20	2	

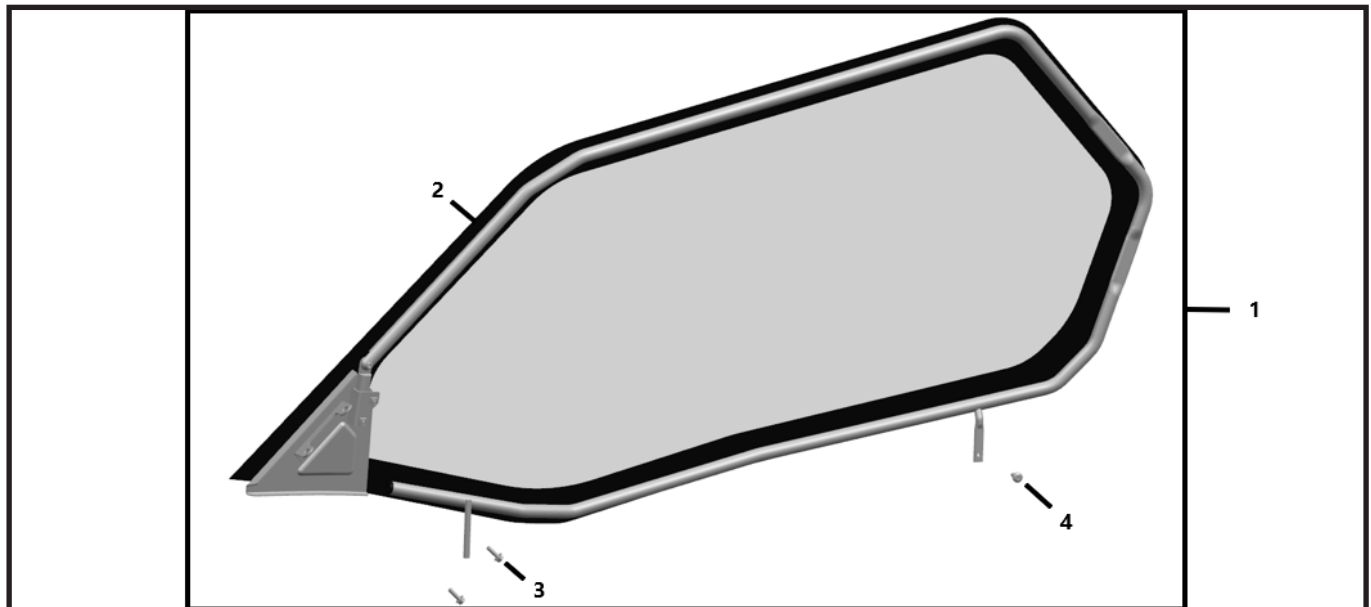

TOOL LIST:

ITEM	DESCRIPTION	QTY.	REMARK
1	ALLEN WRENCH s=6mm	1	Recommended tools
2	SOCKET 10mm	1	
3	PROTECTIVE GLOVES	1	
4	ELECTRIC DRILL	1	

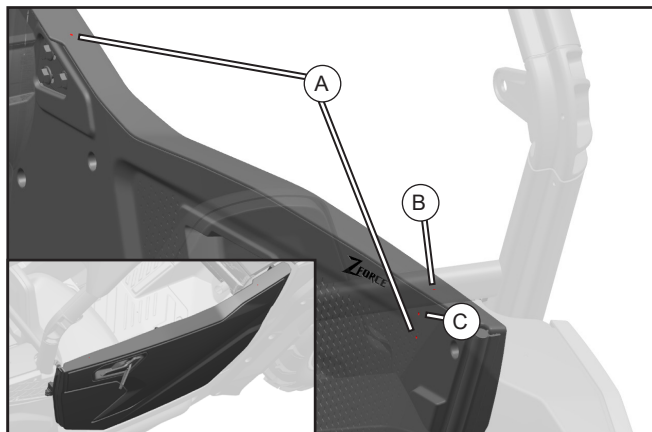

- // Drill 10 mm holes through the plastic only at the reserved marks (A) of the door with an electric drill.
- // Drill a 15 mm hole through the plastic only at the reserved mark (B) of the door with an electric drill.

i Threaded holes are located behind the door plastic at location (A). Use caution while drilling to ensure they are not damaged. Installing bolt (4) at location (c) is optional. The recommended installation method is location (b).

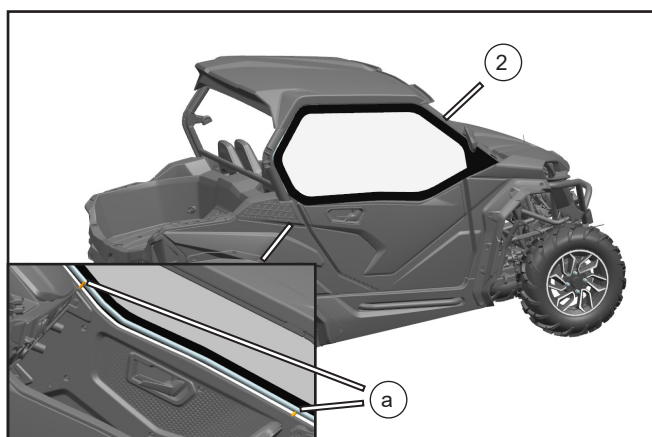

- // Place the soft upper door (2) into the assembly position and insert the frame into the drilled holes (a).

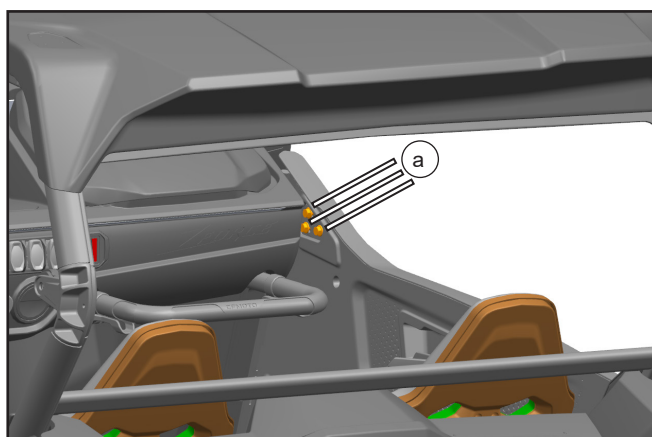

- // Loosen the 3 bolts (a) at the front of the door, then push down the soft door frame and tighten the bolts (a).

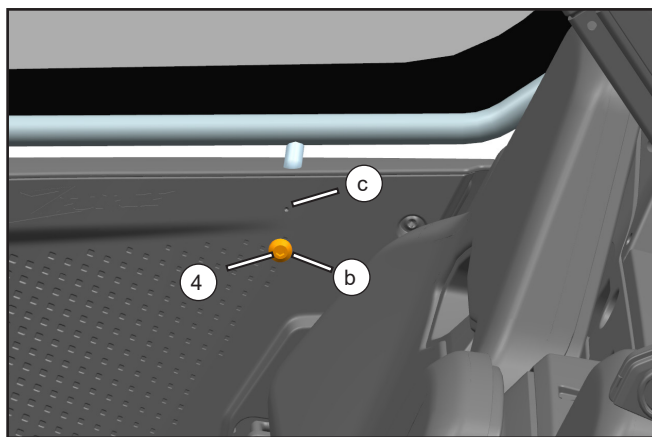

- // Install bolt (4) at drilled hole (b), and tighten it to secure the upper door frame.

i Installing bolt (4) at location (c) is optional. The recommended installation method is location (b).

ASSEMBLY and INSTALLATION

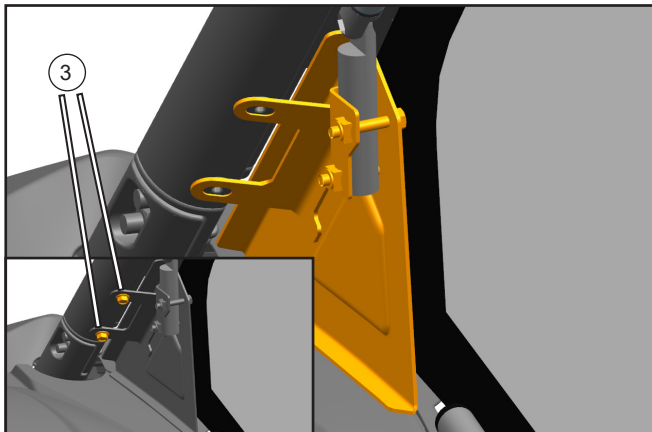

// Install bolts (3) in the holes reserved at front frame column and tighten to secure the corner bracket.

i The corner window bracket has elongated holes for adjusting the appropriate position to ensure proper sealing.