

## ACCESSORY SETUP INSTRUCTION

### CARGO BOX COVER ASSEMBLY -- PN: 5BWV-804400-5000

VALID FOR: **MY2023 and Newer ZFORCE 800/950/1000 Trail Models**

**BEFORE YOU BEGIN:** Read and understand the instructions before starting any work. Make sure that all parts are ready and that you have all the tools required for assembly.

**NOTE:** CFMOTO shall not be liable for any damage caused by incorrect assembly. CFMOTO recommends that all original accessories be assembled by an authorized CFMOTO dealer.

Before assembly, park the vehicle on a flat surface, put the transmission gear into Park (P) and turn off the key switch.

**Zhejiang CFMOTO Power Co., Ltd.** All rights reserved. Reproduction of this document, even in part, as well as copying of all kinds, is permitted only with the express written permission of the copyright owner.

### MEANING OF SYMBOLS



- Indicates information with more details or tips.



- Indicates information of warning or danger.

### PARTS LIST:

ITEM	PART NAME	PART NUMBER	QTY.	REMARK
1	CARGO MAT	5BYV-223044-7000	1	For structure reference only
2	CARGO BOX COVER	5BWV-804410-5000	1	
3	INNER HEX SELF-TAPPING SCREW ST4.8x40	5BWV-040006-5000	4	
4	CARGO BOX COVER ASSEMBLY	5BWV-804410-5000	1	

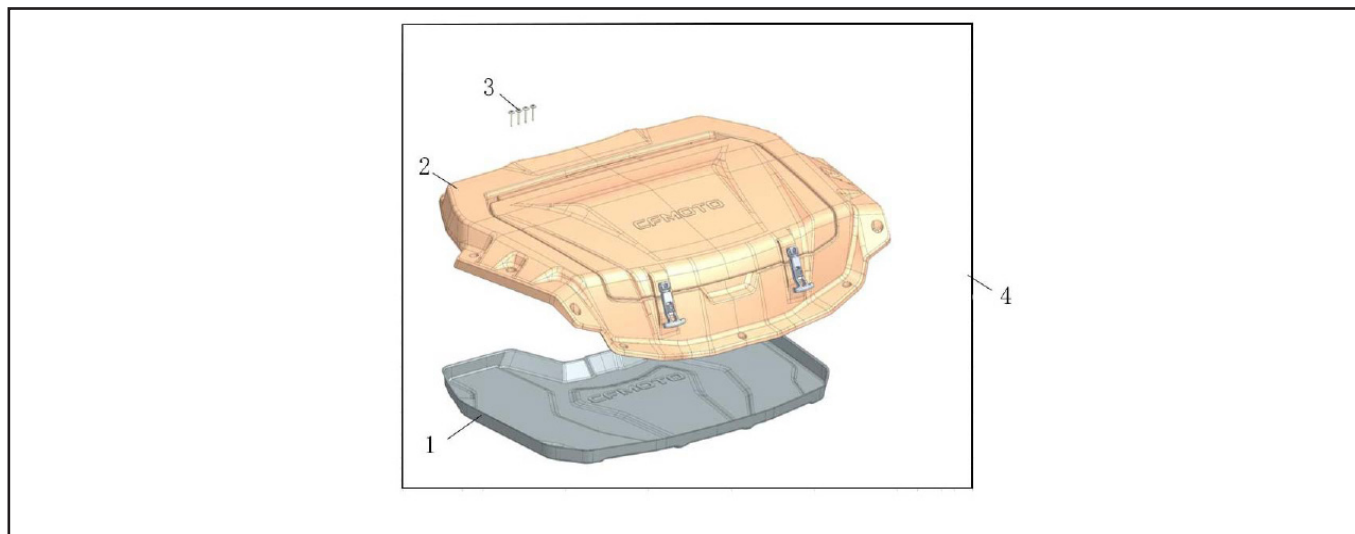

### TOOL LIST:

ITEM	DESCRIPTION	QTY.	REMARK
1	PROTECTIVE GLOVES	1	Recommended tools
2	ELECTRIC WRENCH	1	
3	5mm HEXAGON SOCKET BIT	1	

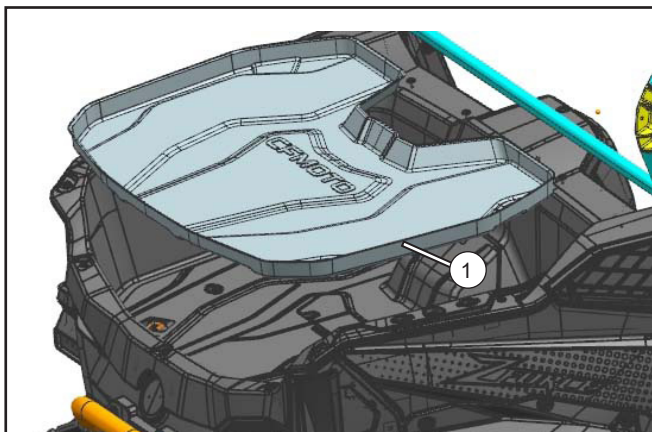

// Set the cargo mat (1) into the cargo box at the rear of the vehicle.

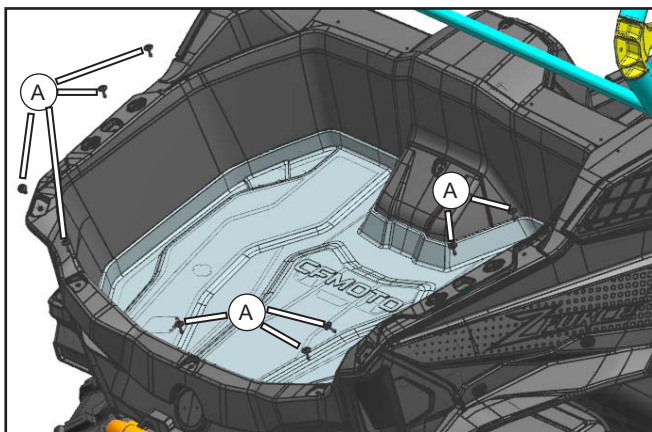

// Remove the M6x20 screws (A) from the top edge of the rear cargo box.

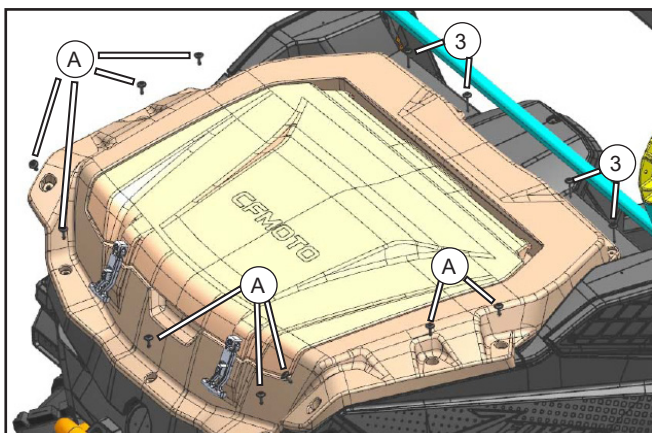

// Place the cargo box cover into the assembly position as shown.  
 // Fasten the cover using the removed M6x20 screws (A) and add inner hex self-tapping screws (3) to the locations shown.  
 // The cargo box cover assembly is complete.