

## ACCESSORY SETUP INSTRUCTION

### REAR WINDSHIELD ASSEMBLY -- PN 5BWV-805200-5000

VALID FOR: ZFORCE 800 TRAIL

**BEFORE YOU BEGIN:** Read and understand the instructions before starting any work. Make sure that all parts are ready and that you have all the tools required for assembly.

**NOTE:** CFMOTO shall not be liable for any damage caused by incorrect assembly. CFMOTO recommends that all original accessories be assembled by an authorized CFMOTO dealer.

Before assembly, park the vehicle on a flat surface, put the transmission gear into Park (P) and turn off the key switch.

**Zhejiang CFMOTO Power Co., Ltd.** All rights reserved. Reproduction of this document, even in part, as well as copying of all kinds, is permitted only with the express written permission of the copyright owner.

### MEANING OF SYMBOLS

 - Indicates information with more details or tips.

 - Indicates information of warning or danger.

### PARTS LIST:

ITEM	PART NAME	PART NUMBER	QTY.	REMARK
1	REAR WINDSHIELD ASSEMBLY	5BWV-805200-5000	1	Picture is for structure reference only.
2	REAR WINDSHIELD	5BWV-805201-5000	1	
3	CLAMP	5ASV-804100-6000	4	
4	SPONGE STRAP	6KM#-040066-8000	4	
5	DAMPING RUBBER STRAP	5BWV-805200-5000-20	1	
6	THREAD LOCKER	5BWV-805200-5000-23	1	
7	T25 ALLEN WRENCH	5BWV-805200-5000-24	1	

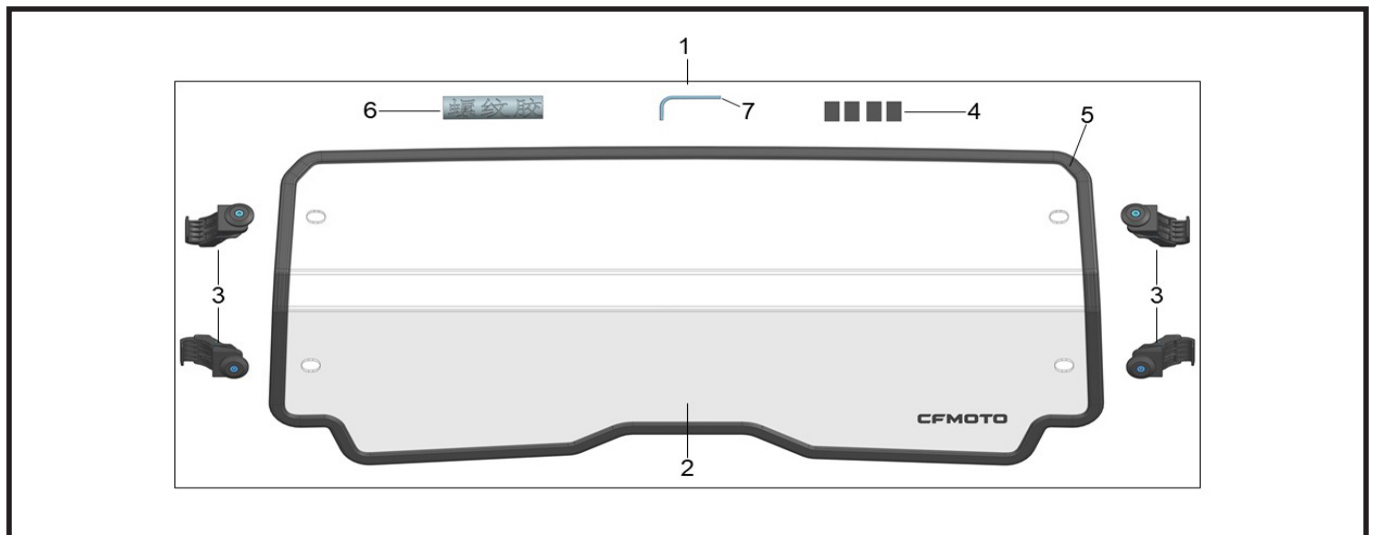

### TOOL LIST:

ITEM	DESCRIPTION	QTY.	REMARK
1	PROTECTIVE GLOVES	1	Recommended Tools
2	4mm ALLEN WRENCH	1	

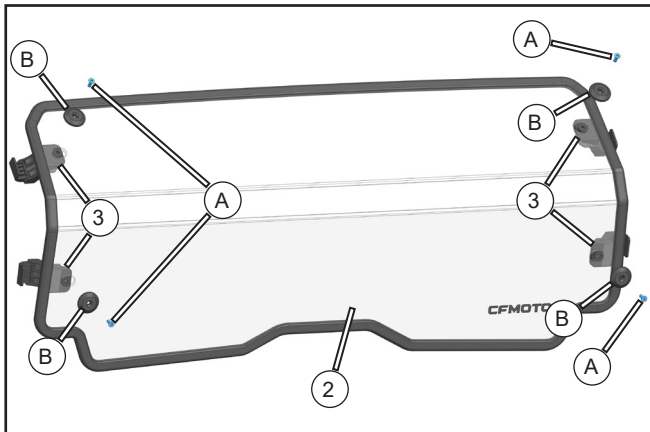
**ASSEMBLY and INSTALLATION**

// Remove the gaskets (B) and screws (A) from the clamps (3), then install the clamps (3) onto the rear windshield (2) with the gaskets (B) and screws (A). *Do not fully tighten bolts at this time.*

**i** Remove the protective film from the windshield surface. Apply some thread locker to the screw.

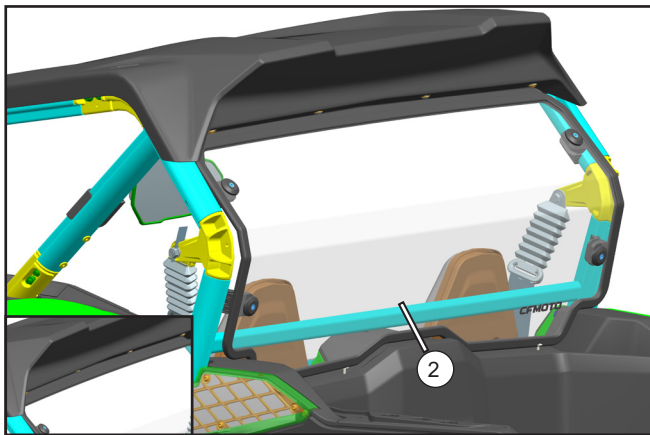

// Tilt the windshield assembly (2) and position it between the top roof and the top bar front assembly.

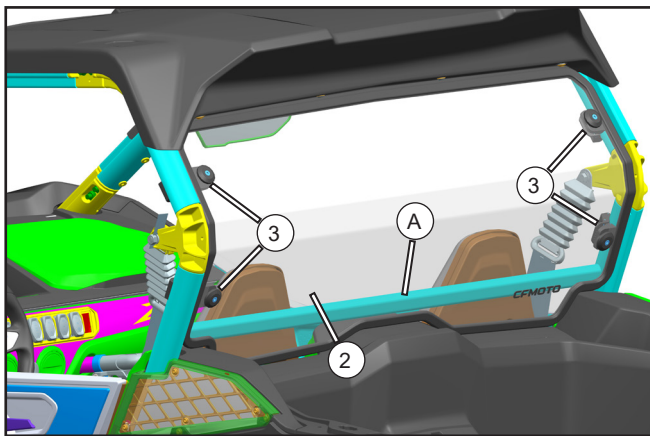

// As shown to determine the clamp positions, then assemble each side with clamps (3). Tighten the screws sufficiently, using care not to over-tighten.

**i** You can decide whether to stick the sponge strip (4) to the position of the frame (A).



// The rear windshield assembly is assembled.