



ACCESSORY SETUP INSTRUCTION

REAR BUMPER ASSY. -- PN 5BWV-801200-5000

VALID FOR: MY2022 and Newer ZFORCE 800 Trail/EX

BEFORE YOU BEGIN: Read and understand the instructions before starting any work. Make sure that all parts are ready and that you have all the tools required for assembly.

NOTE: CFMOTO shall not be liable for any damage caused by incorrect assembly. CFMOTO recommends that all original accessories be assembled by an authorized CFMOTO dealer.

Before assembly, park the vehicle on a flat surface, put the transmission gear into Park (P) and turn off the key switch.

Zhejiang CFMOTO Power Co., Ltd. All rights reserved. Reproduction of this document, even in part, as well as copying of all kinds, is permitted only with the express written permission of the copyright owner.

MEANING OF SYMBOLS



- Indicates information with more details or tips.



- Indicates information of warning or danger.

PARTS LIST:

ITEM	PART NAME	PART NUMBER	QTY.	REMARK
1	REAR BUMPER ASSY.	5BWV-801200-5000	1	Picture is for structure reference only.
2	REAR BUMPER	5BWV-801210-5000	1	
3	HEX FLANGE BOLT M8×30	30006-060030870	2	
4	DECO PLUG	5BY#-801302-1000	2	
5	HEX FLANGE BOLT M8×30	30006-080025870	2	
6	PLUG	5BWV-801100-5000-21	2	Pre-installed

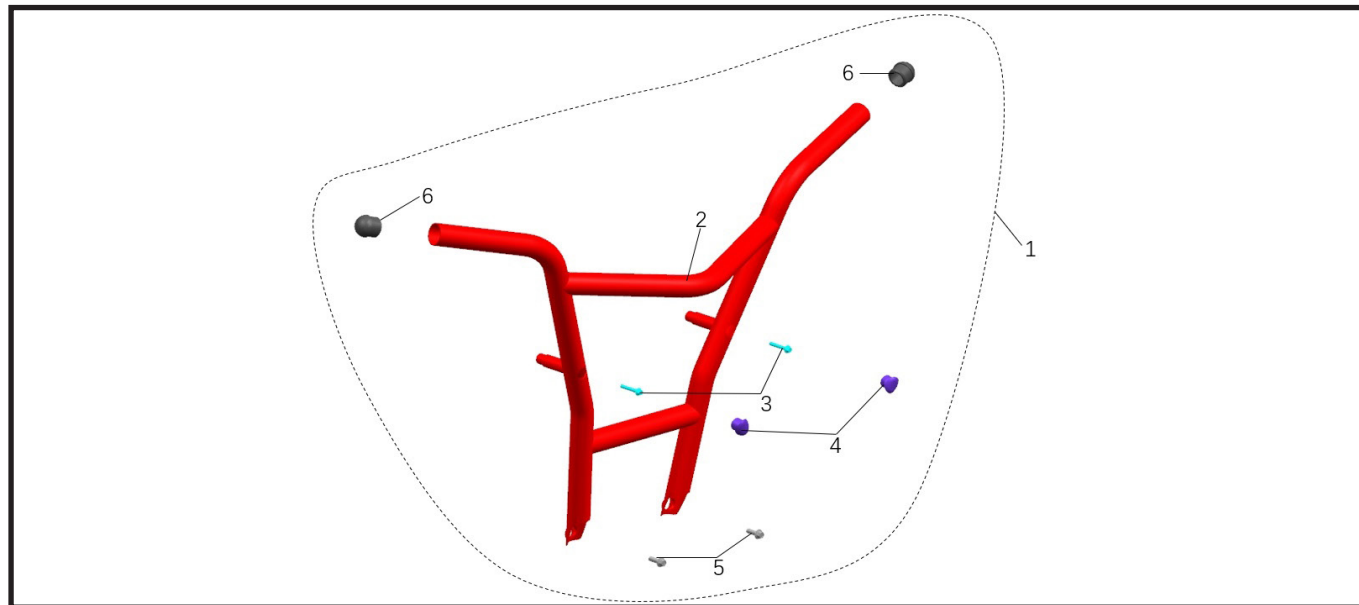

TOOL LIST:

ITEM	DESCRIPTION	QTY.	REMARK
1	PROTECTIVE GLOVES	1	Recommended tools
2	SOCKET 8 MM	1	
3	SOCKET 10 MM	1	

ASSEMBLY and INSTALLATION

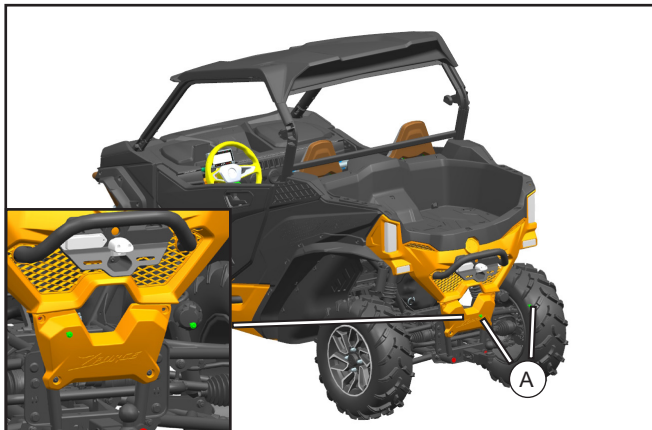

// Remove the original screw (A) as shown.

i -The removed screws will not be reinstalled.

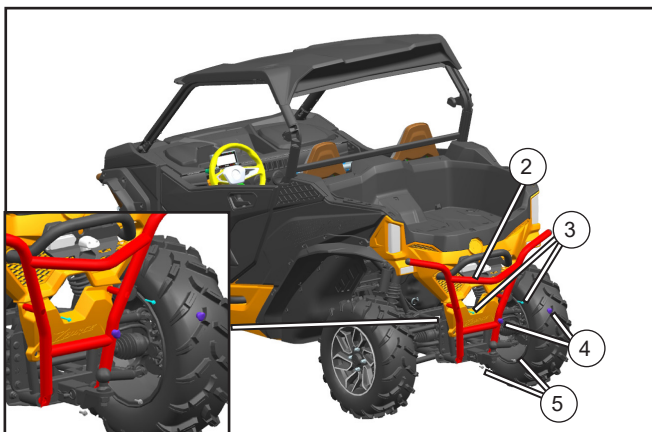

// Place the rear bumper (2) at the assembly position. Install the bolts (3) at upper position and bolts (5) at the lower position, then tighten them sufficiently. Install the deco plug (4) onto the head of bolt (3).

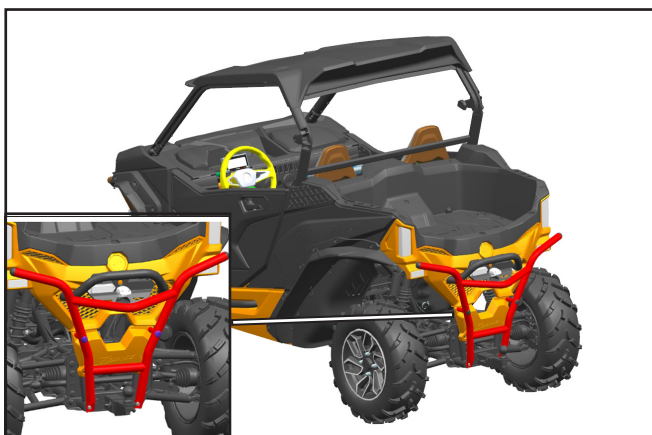

// Rear bumper assembly is complete.