

ACCESSORY SETUP INSTRUCTION

FRONT BUMPER ASSY -- PN 9DQV-801100-3000

VALID FOR: CFORCE 400 & 400 TOURING 500 & 500 TOURING

BEFORE YOU BEGIN: Read and understand the instructions before starting any work. Make sure that all parts are ready and that you have all the tools required for assembly.

NOTE: CFMOTO shall not be liable for any damage caused by incorrect assembly. CFMOTO recommends that all original accessories be assembled by an authorized CFMOTO dealer.

Before assembly, park the vehicle on a flat surface, put the transmission gear into Park (P) and turn off the key switch.

Zhejiang CFMOTO Power Co., Ltd. All rights reserved. Reproduction of this document, even in part, as well as copying of all kinds, is permitted only with the express written permission of the copyright owner.

MEANING OF SYMBOLS

 - Indicates information with more details or tips.

 - Indicates information of warning or danger.

PARTS LIST:

ITEM	PART NAME	PART NUMBER	QTY.	REMARK
1	FRONT BUMPER ASSY	9DQV-801100-3000	1	Picture is for structure reference only.
2	FRONT BUMPER	9DQV-801110-3000	1	
3	BOLT M8×60	30006-080060830	2	
4	BOLT M8×20	30006-080020870	2	
5	NUT	30202-080870	4	

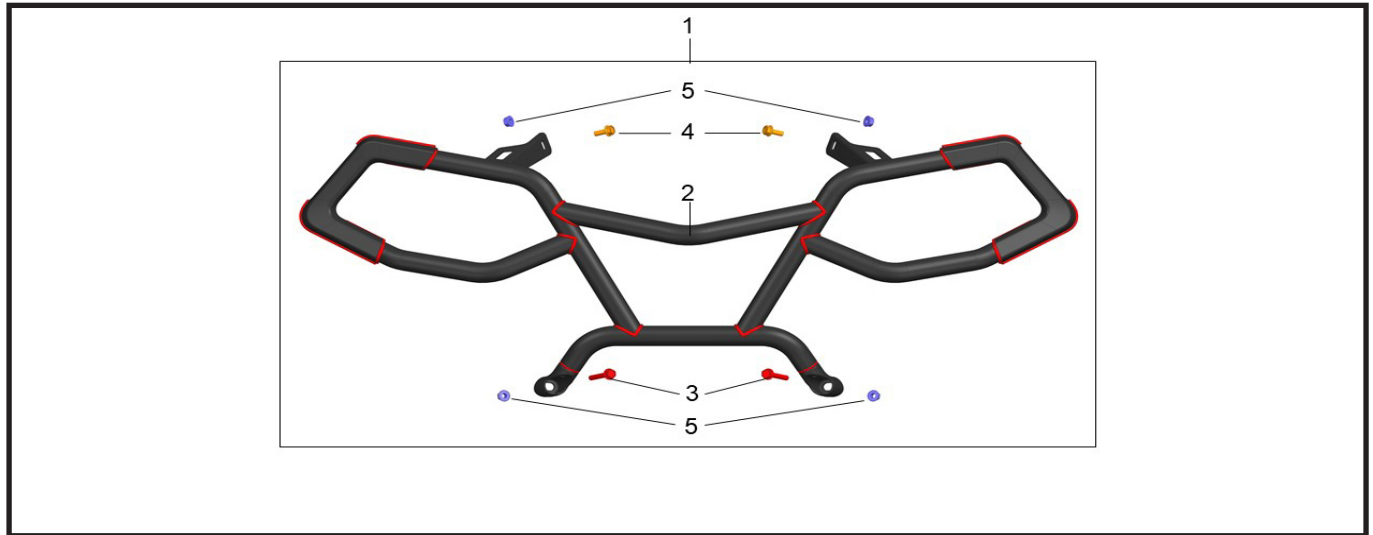

TOOL LIST:

ITEM	DESCRIPTION	QTY.	REMARK
1	PROTECTIVE GLOVES	1	Recommended tools.
2	13mm SOCKET	1	
3	ELECTRIC WRENCH	1	
4	13mm OPEN END WRENCH	1	

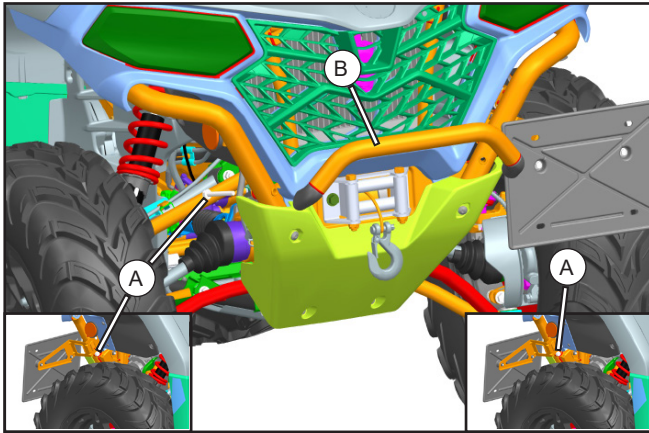
ASSEMBLY and INSTALLATION

// Unscrew the bolts (A) and remove the original front bumper (B).

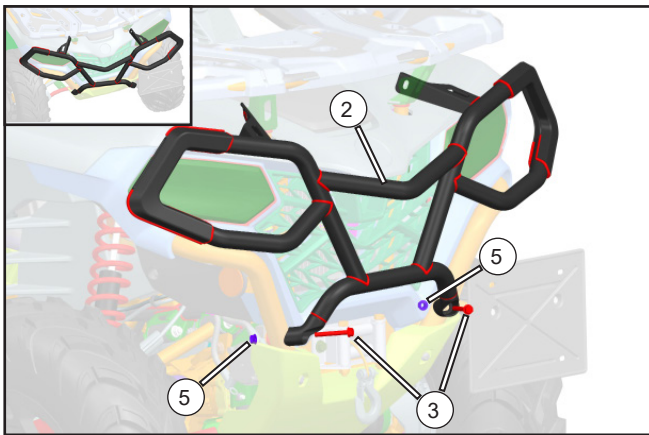

// Tilt the front bumper (2) to a proper position and secure it to the front bracket with bolts (3) and nuts (5) on both sides of the bottom. Do not fully tighten at this time.

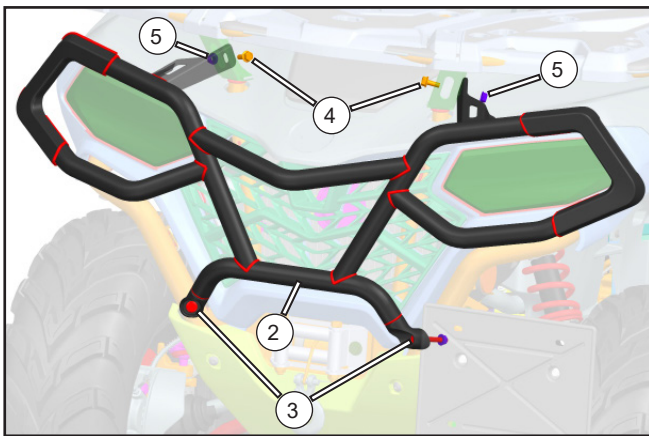

// Secure the two sides above the front bumper (2) to the front rack with bolts (4) and nuts (5).
// Tighten the bolts (3) and nuts (5).

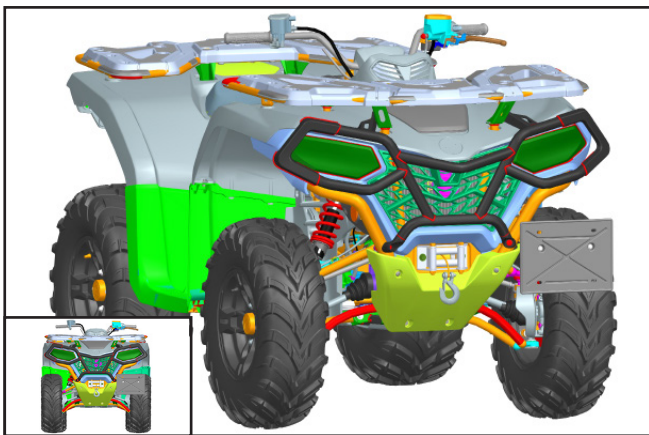

// The front bumper is assembled.