

ACCESSORY SETUP INSTRUCTION

REAR CARGO BOX ASSY - PN 9DQV-806100-3001

VALID FOR: MY2023 and newer CFORCE 400 & 500

BEFORE YOU BEGIN: Read and understand the instructions before starting any work. Make sure that all parts are ready and that you have all the tools required for assembly.

NOTE: CFMOTO shall not be liable for any damage caused by incorrect assembly. CFMOTO recommends that all original accessories be assembled by an authorized CFMOTO dealer.

Before assembly, park the vehicle on a flat surface, put the transmission gear into Park (P) and turn off the key switch.

Zhejiang CFMOTO Power Co., Ltd. All rights reserved. Reproduction of this document, even in part, as well as copying of all kinds, is permitted only with the express written permission of the copyright owner.

MEANING OF SYMBOLS

 - Indicates information with more details or tips.

 - Indicates information of warning or danger.

PARTS LIST:

ITEM	PART NAME	PART NUMBER	QTY.	REMARK
1	REAR CARGO BOX ASSY	9DQV-806100-3001	1	For structure reference only
2	REAR CARGO BOX	9DQV-806110-3001	1	
3	CF CONNECT CLAMP	9DS#-809000-6000	2	
4	QUICK RELEASE BASE ASSY	9DQV-809100-3000	6	For CForce 400 only. Need to be purchased separately.

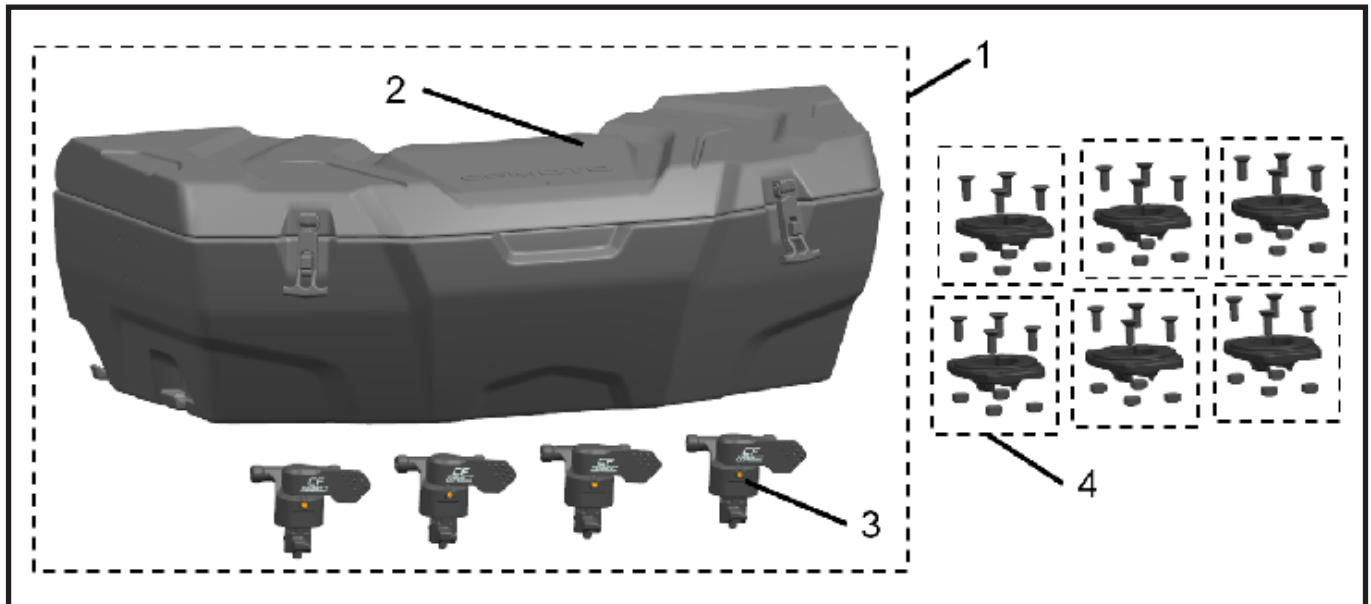

TOOL LIST:

ITEM	DESCRIPTION	QTY.	REMARK
1	5mm ALLEN WRENCH	1	Recommended tools. Not included in accessory material.
2	4mm ALLEN WRENCH	1	
3	PROTECTIVE GLOVES	1	

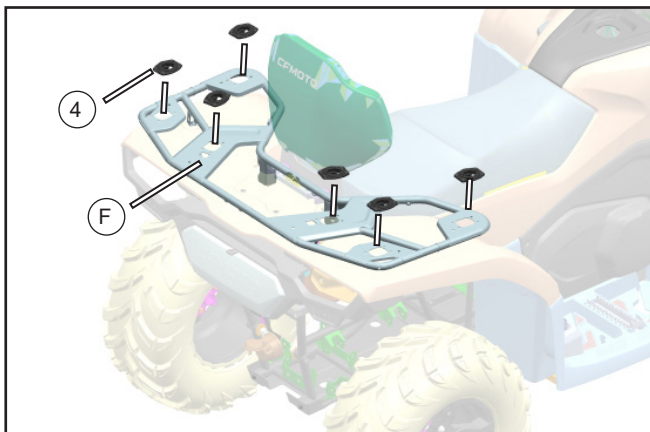
ASSEMBLY and INSTALLATION

CFORCE 400:

// Install 6 quick release base assemblies (4) on the rear rack(F) as shown.

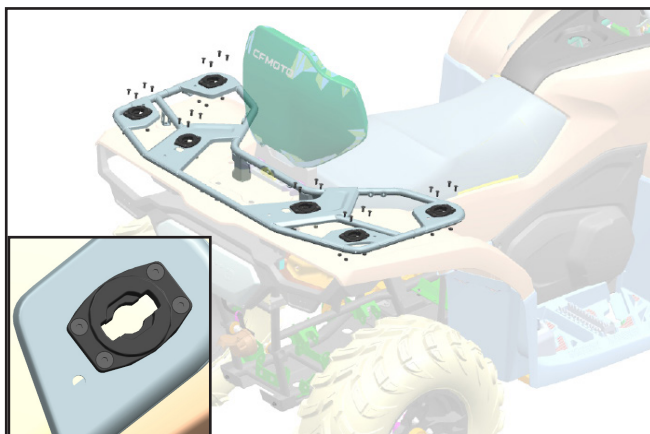

CFORCE 400:

// Install the screws and bolts to secure quick release base assy.

i - CFORCE 400 Only. Base assemblies are purchased separately.

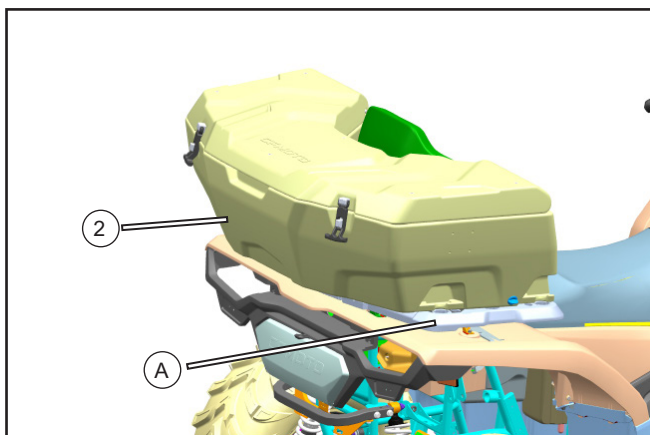

CFORCE 400 and 500:

// Put rear cargo box (2) onto the rear rack (A), and align the quick release hole of cargo box (2) with assembly position on rack (A).

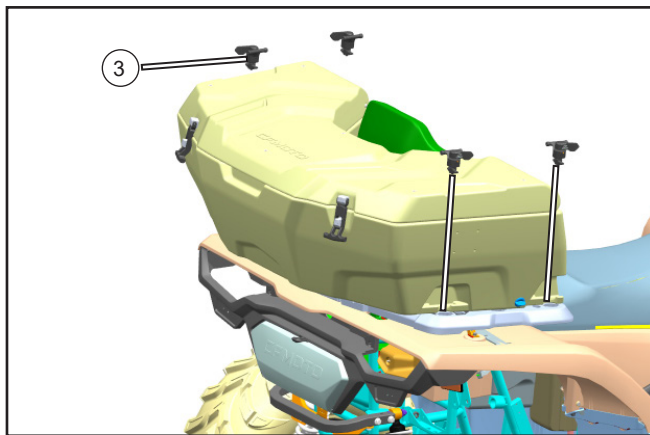

// Install the CF connect clamp (3) at corresponding positions, and turn them anti-clockwise to lock them.

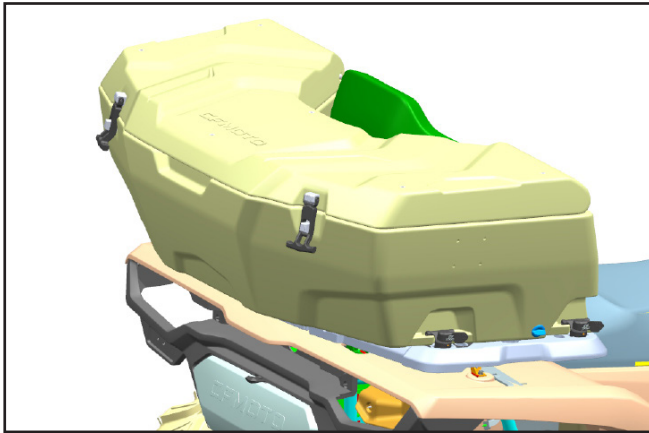

// The installation is complete.